

REMOVE STUDENTS FROM GROUPS

There may be times when you need to remove a student or students from a group in ulearn.

Instructions

1. Under **Course Management** on the left menu, click on **Users and Groups** and then **Groups**.

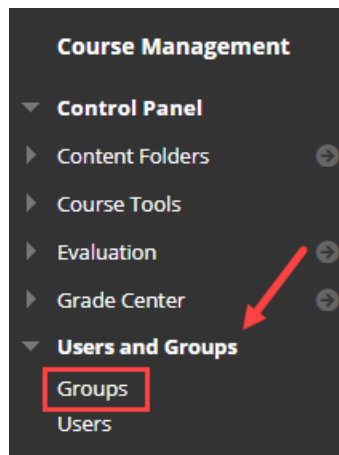

2. On the **Groups** page, to edit a Single Group, click the down arrow icon next to the group you wish to edit and select **Edit Group** from the list.

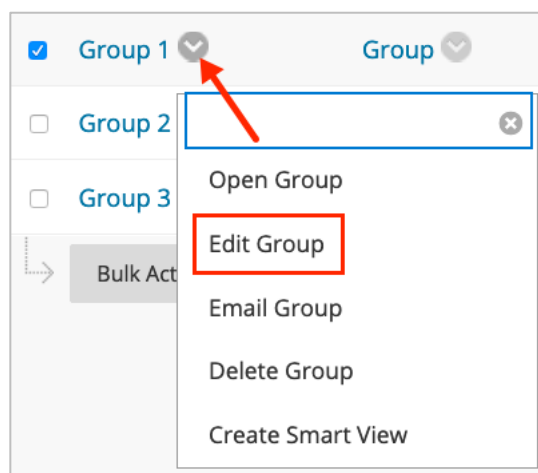



3. On the next page, scroll to the Membership section of the page. Next to the student's name, click on the **X** located on the right side of the page to remove the student or students.

REMOVE STUDENTS FROM GROUPS

MEMBERSHIP

Add Users Remove All Users

USERNAME	FIRST NAME	LAST NAME	ROLE	
 mary_sky_student	Mary	Sky-Student	Student	

- The student has been removed from the group and is no longer listed. Repeat steps 2-3 for any additional students in other groups that need removing.

MEMBERSHIP

Add Users

No users have been added.

Success: Enrollment deleted.

- Click **Submit** when done.

Cancel Submit